

For Enquiry Contact:

Builders and Developers



B-24/24A, Aniraj Tower, Opp. Kaka Petrol Pump, L.B.S. Marg,  
Bhandup (West), Mumbai-400 078.  
Tel. No- (022) 25953949 / 48.  
E-mail: sudhanshu\_infra@yahoo.in | www.sudhanshuinfra.com

Architect  
**R. P. Asundaria**  
Mulund (West)

RCC Engineer  
**Vinayak Chopdekar & Associates**  
Thane (West)

Legal Advisor  
**G. S. Bhat**  
Mulund (West)



## Location Map



**Site Address:**  
**VISHNU BHASKAR Co-op. Hsg. Society Ltd.,**  
C.T.S. No-999, Plot No-10,  
Damle Colony Road, Kanjurmarg (East), Mumbai-400 042.

Note:  
The conditions of the brochure are purely conceptual and have no legal binding on us.  
Developers reserve the right to amend the layouts, elevation and colour schemes, specifications and other amenities without prior notice.

## Basic elements of life



All Integrated

**VISHNU BHASKAR**  
Co-op. Hsg. Society Ltd.



### Welcome to Vishnu Bhaskar

Stretching 7 storeys residential into the rapidly transforming suburban skyline, Vishnu Bhaskar welcomes you with premium luxury residences in a choice of formats. A dreamy paradise of exquisite detailed 1 and 2 BHK abodes. The homes with their optimally laid out interiors, modern facilities and striking spaces truly make these abodes premier quality residences.

The location of Kanjurmarg (E) naturally, gives residents of Vishnu Bhaskar a big lifestyle advantage. Since every life and lifestyle necessity like schools, malls, multiplexes, restaurants, health centres and more are located within convenient reach.



HOME TOWN in Vikroli



D-MART at Kanjurmarg Station (West)



Kids Play Ground in Kanjurmarg



Western Express Highway



Near by Kanjurmarg & Bhandup Station

## VISHNU BHASKAR Front View



VISHNU BHASKAR  
Back View

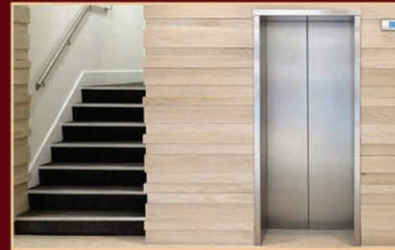

SITE LAYOUT PLAN

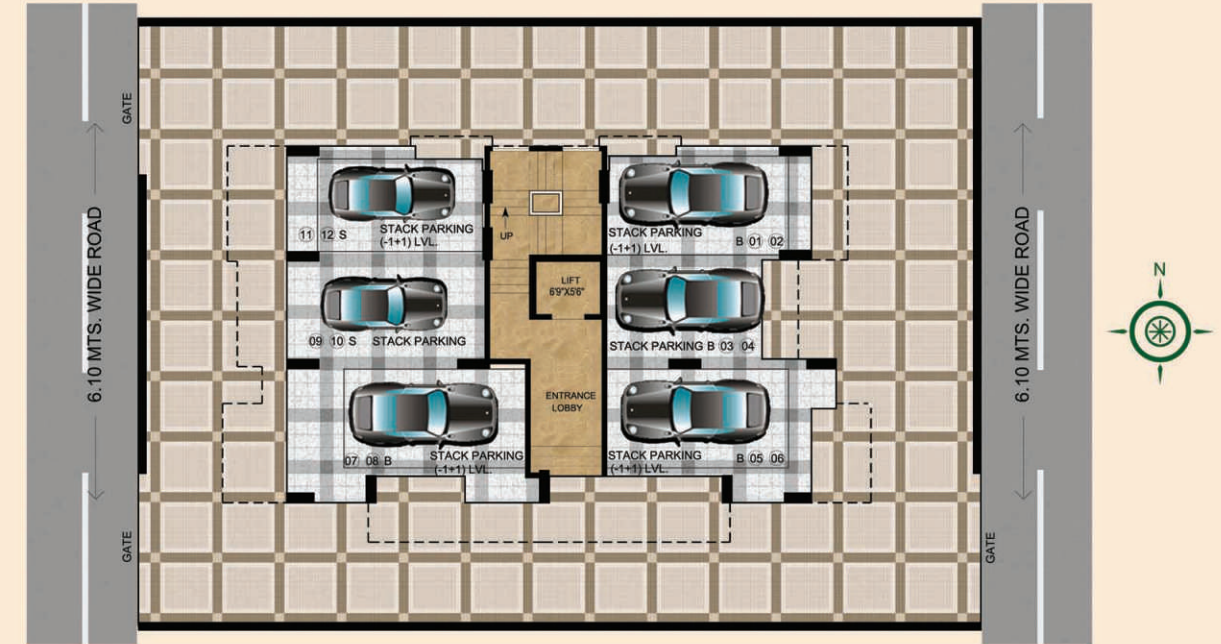

Common Area Highlights

High-speed elevator - Johnson & Johnson company | Ample lighting at parking levels and in landscape areas | Power backup for common lighting & lift | Two level stake parking | Access control system at main lobby | Elegantly designed main entrance lobby | Vitrified Flooring with skirting in typical lift lobby | Glass fence fitting for Terrace flat

**VISHNU BHASKAR**  
Co-op. Hsg. Society Ltd.  
It's all right here ....



◀ **5th & 6th Floor 3D View**  
**1 BHK**

- A Living Room
- B Master Bedroom
- C Kitchen
- D Washroom



**7th Floor 3D View** ▶  
**2 BHK (Terrace Flat)**

- A Living Room
- B Bedroom
- C Common Washroom
- D Kitchen
- E Master Bedroom
- F Master Washroom
- G Terrace

**4th FLOOR PLAN**



- 401 1BHK
- 402 1BHK + TERRACE
- 403 1BHK + TERRACE
- 404 1BHK + TERRACE

5th & 6th FLOOR PLAN



501 & 601 1BHK  
 502 & 602 1BHK  
 503 & 603 1BHK  
 504 & 604 1BHK



7th FLOOR PLAN



701 2BHK + TERRACE





## INTERNAL AMENITIES



*Live life extraordinaire....*

### LIVING ROOM

- French windows (full height windows) attached to living rooms.
- Concealed wiring with appropriate switches and circuit breaker.
- Video door phone.
- Vitrified flooring with skirting.
- Concealed telephone and cable point provided.
- Split Air condition for living room.
- All internal wall s with POP finish and OBD paint.

### BEDROOMS

- Wooden flooring with skirting.
- Master Bedrooms with attached bathroom.
- Designer lights and Modular switches.
- Split Air condition Unit in bedroom.

### KITCHEN

- Vitrified flooring and Granite counter top with stainless steel sink & drain board.
- Aquaguard Water purifier & Exhaust fan in Kitchen.

- Decent and attractive tiles for kitchen walls.
- Stainless steel sink

### BATHROOMS

- Anti-skid tiles for the floor and fully glazed tiles up to ceiling for the walls.
- Jaguar fitting.
- Geyser & Exhaust fan
- Concealed plumbing with Quality sanitary fittings and sanitary ware of reputed brand.
- Stylish wash basin.

### BALCONIES

- Weather coat emulsion paint will be applied.
- Glass fence fitting for terrace flat.
- Vitrified flooring with skirting.

